



FLEETRANNER™ GREEN STRIPE VULCO-FLEX™ HOSE

PRODUCT TYPE:

COOLING SYSTEMS

RECOMMENDED FOR:

Flexible, textile-reinforced radiator hose with built in helical wire to reduce kinking and collapsing. In many applications this hose can be used as a replacement for curved hose.

RESISTANT TO:

Designed for heavy-duty radiator applications.

CONSTRUCTION:

SHAPE: Straight
TUBE: EPDM
REINFORCEMENT: Wire
WIRE: Vulcanised Metal Wire
COVER: EPDM / NEOPRENE

STANDARDS:

SAE NORM SAE 20R1 type EC class D
DIN NORM -

TEMPERATURE:

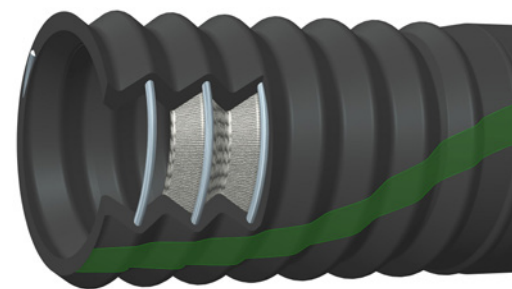

Gates	PN	↔ 1		↔ 2		⊘ 1	⊘ 2	↔	⌚	💥
		mm	"	mm	"	mm	mm	m	bar	bar
VF101ES	4284-00101	50	2	50	2	59	59	0.61	2.8	6.9
VF102ES	4284-00102	57	2 1/4	57	2 1/4	66	66	0.229	2.8	6.9
VF103ES	4284-00103	57	2 1/4	57	2 1/4	66	66	0.279	2.8	6.9
VF104ES	4284-00104	57	2 1/4	57	2 1/4	66	66	0.356	2.8	6.9
VF105ES	4284-00105	57	2 1/4	57	2 1/4	66	66	0.432	2.8	6.9
VF106ES	4284-00106	57	2 1/4	57	2 1/4	66	66	0.483	2.8	6.9
VF107ES	4284-00107	50	2	50	2	59	59	0.508	2.8	6.9
VF108ES	4284-00108	50	2	63	2 1/2	59	72	0.508	2.8	6.9
VF109ES	4284-00109	57	2 1/4	63	2 1/2	66	72	0.457	2.8	6.9
VF110ES	4284-00110	57	2 1/4	63	2 1/2	66	72	0.533	2.8	6.9
VF111ES	4284-00111	63	2 1/2	63	2 1/2	72	72	0.61	2.8	6.9
VF112ES	4284-00112	63	2 1/2	63	2 1/2	72	72	0.406	2.8	6.9
VF113ES	4284-00113	50	2	50	2	59	59	0.369	2.8	6.9
VF114ES	4284-00114	50	2	50	2	59	59	0.432	2.8	6.9
VF115ES	4284-00115	50	2	50	2	59	59	0.311	2.8	6.9
VF116ES	4284-00116	76	3	76	3	85	85	0.94	2.8	6.9
VF117ES	4284-00117	70	2 3/4	70	2 3/4	79	79	0.813	2.8	6.9
VF118ES	4284-00118	50	2	57	2	59	66	0.216	2.8	6.9
VF120ES	4284-00120	45	1 3/4	50	1 3/4	54	59	0.483	2.8	6.9
VF121ES	4284-00121	50	2	50	2	59	59	0.241	2.8	6.9
VF122ES	4284-00122	45	1 3/4	45	1 3/4	54	54	0.343	2.8	6.9
VF123ES	4284-00123	45	1 3/4	45	1 3/4	54	54	0.419	2.8	6.9
VF124ES	4284-00124	45	1 3/4	50	1 3/4	54	59	0.419	2.8	6.9
VF125ES	4284-00125	50	2	57	2	59	66	0.445	2.8	6.9



FLEETRANNER™ GREEN STRIPE VULCO-FLEX™ HOSE



	PN									
		mm	"	mm	"	mm	mm	m	bar	bar
VF126ES	4284-00126	57	2 1/4	57	2 1/4	66	66	0.686	2.8	6.9
VF128ES	4284-00128	63	2 1/2	63	2 1/2	72	72	0.279	2.8	6.9
VF130ES	4284-00130	70	2 3/4	70	2 3/4	79	79	0.457	2.8	6.9
VF131ES	4284-00131	50	2	57	2	59	66	0.381	2.8	6.9
VF132ES	4284-00132	57	2 1/4	63	2 1/2	66	72	0.635	2.8	6.9
VF133ES	4284-00133	50	2	57	2	59	66	0.635	2.8	6.9
VF134ES	4284-00134	45	1 3/4	50	2	54	59	0.254	2.8	6.9
VF135ES	4284-00135	45	1 3/4	50	2	54	59	0.597	2.8	6.9
VF136ES	4284-00136	63	2 1/2	63	2 1/2	72	72	0.356	2.8	6.9
VF137ES	4284-00137	50	2	50	2	59	59	0.838	2.8	6.9
VF138ES	4284-00138	63	2 1/2	63	2 1/2	72	72	0.711	2.8	6.9
VF140ES	4284-00140	57	2 1/4	57	2 1/4	66	66	0.61	2.8	6.9
VF141ES	4284-00141	70	2 3/4	70	2 3/4	79	79	0.356	2.8	6.9